

Slimlite

Ultra-slim LED illuminated displays



unibox

The story behind the graphics

Unrivalled LED technology

In conjunction with Lumenal, our specialist LED lighting sister company, we have developed a bespoke light engine to illuminate these ultra-slim graphic displays.

The light engine is produced using high-quality LEDs from Samsung or Osram, and are manufactured right here in the UK, at our Manchester headquarters.

This means we have complete control, not only of how we specify standard and custom sizes, but of the quality and performance of our products.

What this covers includes everything from a ruthless concept development & design phase and judicious colour binning, right through to optimal thermal management properties and consistent lux levels - in each and every display.



Slimlite TFS

Ultra-slim LED tension fabric graphic

We've taken our popular tension fabric system (TFS) aluminium profiles and made an ultra-slim version, allowing us to create our slimmest ever illuminated tension fabric display.

A bespoke, high-quality LED light engine illuminates a dot-matrix patterned light guide plate. This provides an even distribution of light across the taut graphic, which goes neatly into the edge of our newly developed slim-line aluminium tension fabric profile.

The result is a striking illuminated display, featuring graphics which can be changed quickly, easily and cost-effectively.

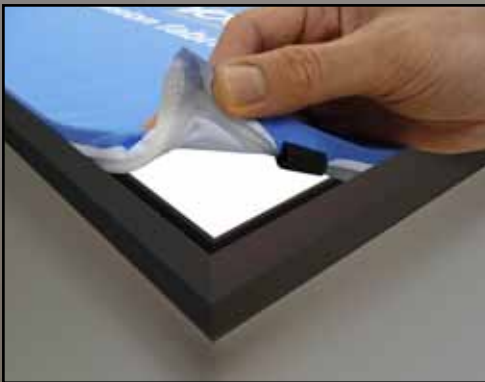

Technical Information

The PCB is integrated into a new 34mm slim TFS aluminium profile. The light emitted travels through a light guide, which uses a dot-matrix pattern to provide evenly distributed illumination to the back-lit graphic.

Standard Dimensions

841mm x 594mm (A1)	1189mm x 841mm (A0)
594mm x 420mm (A2)	2000mm x 500mm
1800mm x 1000mm	1160mm x 1160mm
1300mm x 250mm	1300mm x 500mm
1200mm x 600mm	950mm x 950mm
1000mm x 500mm	524mm x 524mm
450mm x 250mm	

Bespoke Sizes available on request

Technical Specifications

Input Voltage = 110VAC – 240VAC

Input Current = dependent upon size & power of display

Output Voltage = 24VDC

Output Power = dependent upon size & power of display

LED = dependent upon size & power of display

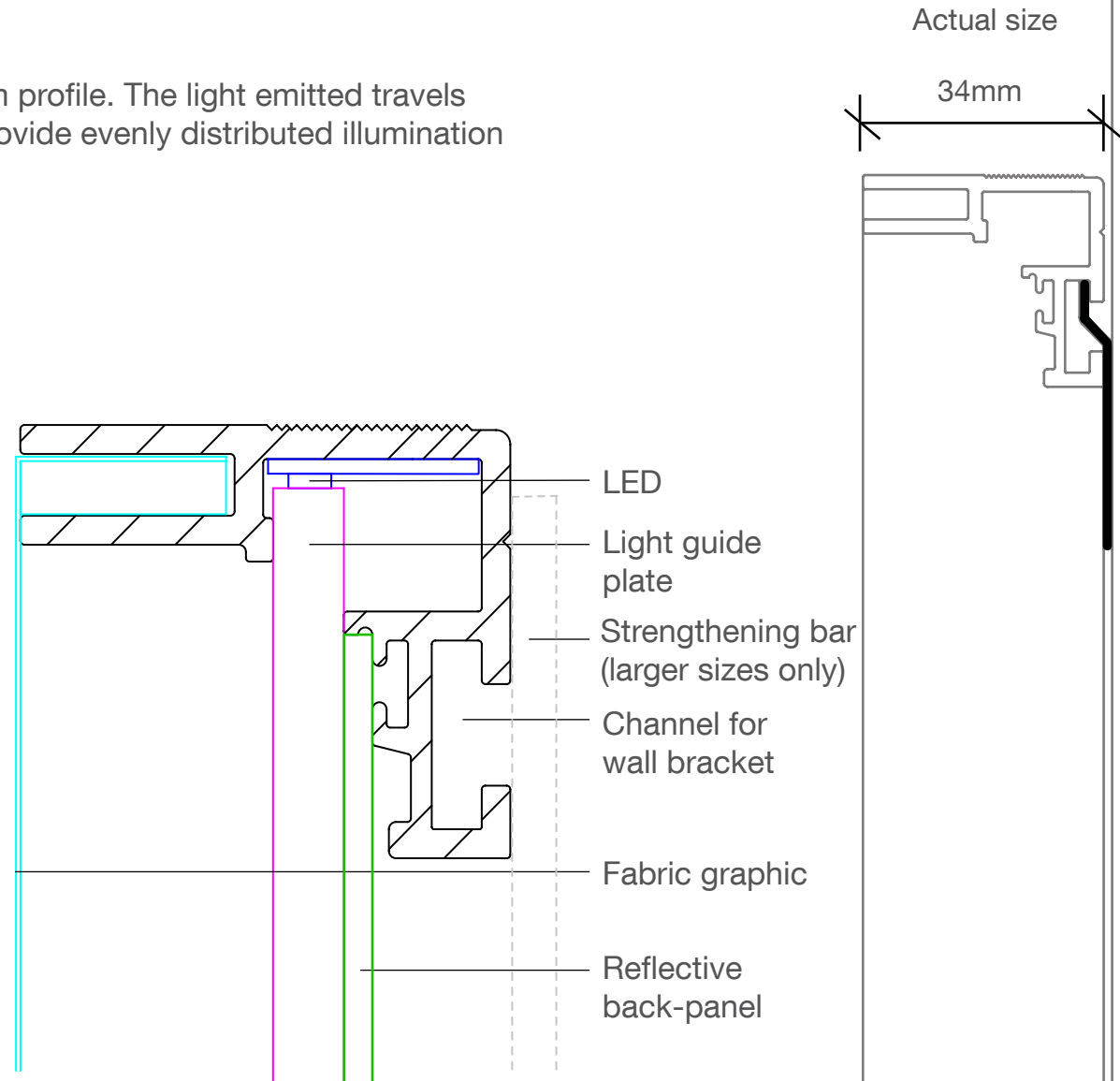

Slimlite Solid

Ultra-slim LED illuminated solid display with permanent graphic

By combining sleek Unibox aluminium extrusions with an edge-lit LED light guide plate, the printed graphic is permanently set, and is flush with the edge of its housing, creating a frameless effect.

Using cast acrylic, high resolution, photo quality media, this display has been developed for when permanent graphics are required.

The end result is a stunning illuminated display, which is perfect for any interior environment, such as retail, corporate or public events.

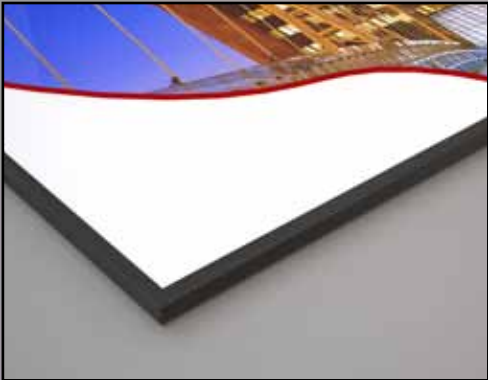

Technical Information

A high quality, 22mm slim, LED illuminated graphic display, featuring a permanently set acrylic graphic panel for integration onto a frameless illumination system.

Standard Dimensions

841mm x 594mm (A1)
1300mm x 500mm
1300 mm x 250mm
1200mm x 600mm

Bespoke Sizes available on request

Technical Specifications

Input Voltage = 110VAC – 240VAC
Input Current = dependent upon size & power of display
Output Voltage = 24VDC
Output Power = dependent upon size & power of display
LED = dependent upon size & power of display

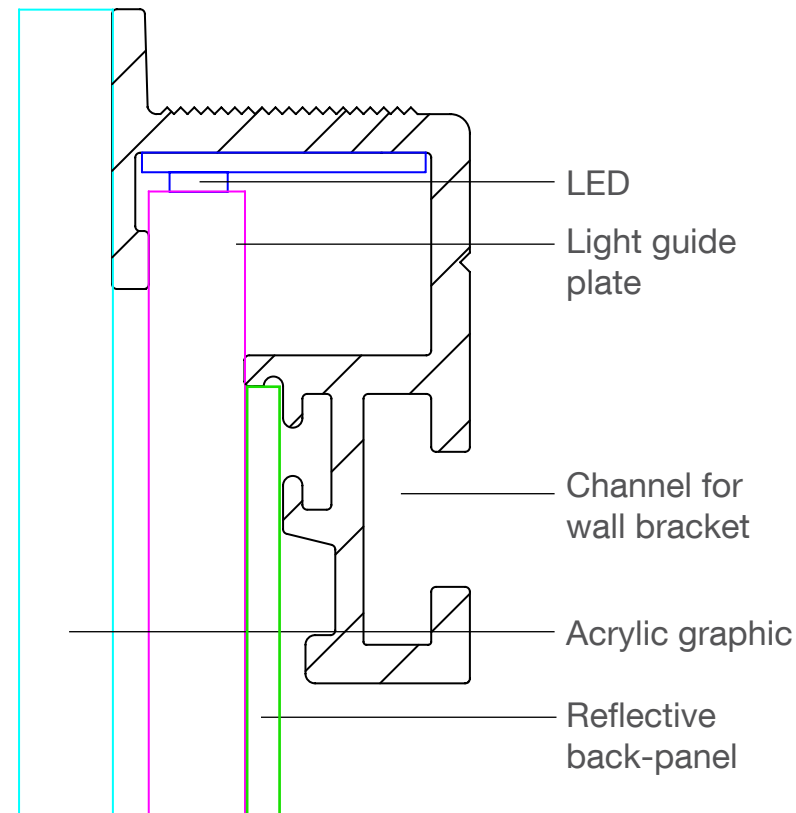

Actual size

22mm

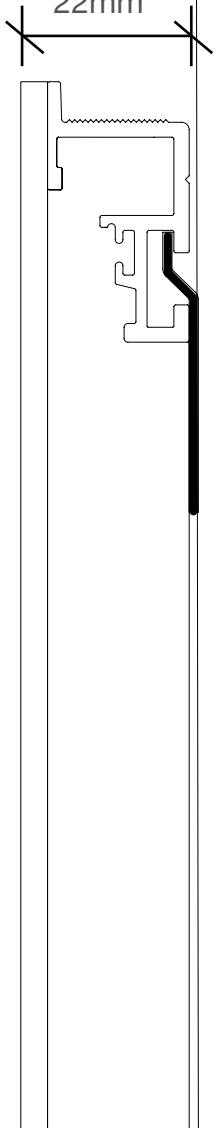

Contact

Samples available on request

Unibox

Greenside Way
Middleton
Manchester
M24 1SW

t: 0845 277 6000

f: 0845 277 6001

e: sales@unibox.co.uk

w: www.unibox.co.uk